

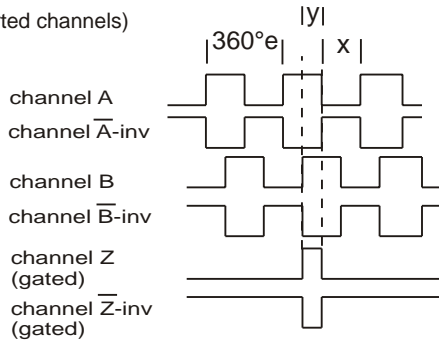

## OUTPUT WAVEFORM

Rotation: Clockwise (cw) from shaftside

(inv = inverted channels)



$X = 180^\circ \pm 36^\circ$  and  $Y = 90^\circ \pm 18^\circ$   
Z puls: Gated with A and B (standard)

Options: TTL or HTL compatible. Open Collector NPN or PNP  
Gated Z-puls or none-gated Z-puls.  
View more Output options in section 15 - page 1

## CONNECTIONS

Color code	Standard	Color code	Differential
Green	Ch A	Pink	Ch A
Yellow	Ch B	Grey	Ch A inv
Grey	Ch Z	Green	Ch B
Brown	Vcc	Yellow	Ch B inv
White	0-Volt	White	Ch Z
		Brown	Ch Z inv
		Red	Vcc
		Blue	0-Volt

## PULSES/REV.

4	30	100	250	600	2048
10	36	125	256	1000	2500
11	50	128	300	1024	3000
12	60	150	360	1250	3600
15	75	180	400	2000	5000
25	90	200	500	2500	7500

## ORDERING CODES

	Options	Ordering codes
Pulses pr.rev.:	No. of pulses	XXXX
Output signal:	Normal (TP-Standard) 3 channel = A, B, Z	N
	TP-Differential, 6 channel A, B, Z and A-inv, B-inv, Z-inv	D
Shaft dimensions:	$\varnothing 4 \times 9$ mm $\varnothing 5 \times 10$ mm $\varnothing 6 \times 10$ mm $1/4'' (\varnothing 6.35) \times 10$ mm	04x09 05x10 06x10 1/4x10
IP-rating:	IP 50 Standard IP 65 (Option)	50 65
Round Cable Length of cable:	Standard 1 meter No. of meters	01 XX
Round Cable Cable take out:	Side Back	S B
Anti rotation spring coupling or Flange / Plate:	View Section 9 page 1 to 6	
Cable and connector options:	View section 20 page 10 to 13	

## Flat Ribbon Cable and/or Connector

### Options

Flat Cable (only IP 50)  
Ribbon + IDC or AMP  
View Section 20 page 10

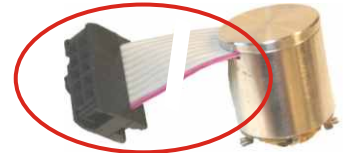

Connector on Encoder:  
(only IP64)  
View Section 20 page 11

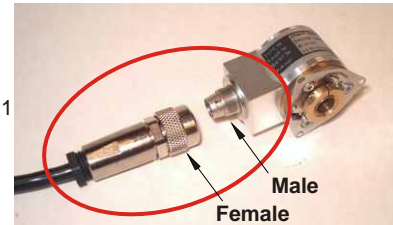

## OPTIONS: Hole dimensions for 2REB - 3 mounting options in one Encoder

### Option A: 4 x M3 in $\varnothing 30$

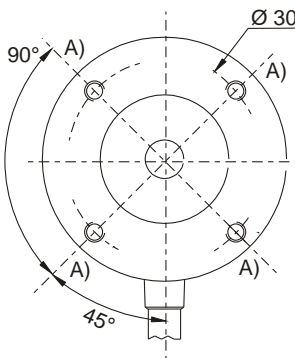

### Option B: 3 x M3 in $\varnothing 30$

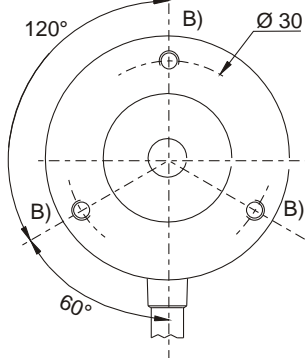

### Option C: 3 x M3 in $\varnothing 28$

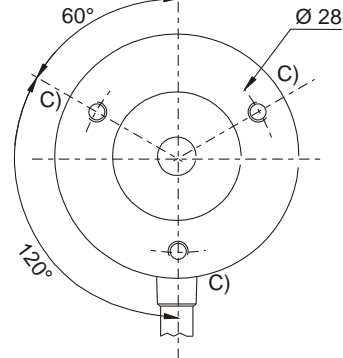

2REB

Hole  
Dimensions

Pulses

Output  
signal

Shaft  
length

X  
Shaft  
length

IP-  
rating

Length of  
round cable

Cable  
take out

Anti Rotation Spring Coupling  
Or Flange / Plate Order Number